

N=Number of Positions

Poles	Tolerance
2p-5p	±0.25
6p-8p	±0.35

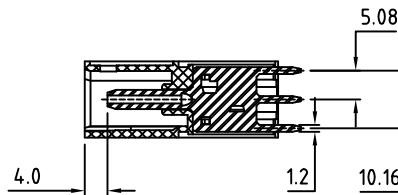
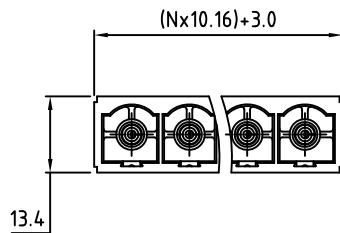

Material:	
Contact Solder Pin:	Copper, Gold Plated
Insulating Body:	Polyamide, UL94V-0
Electrical	
Voltage Rating:	300 VAC
Current rating:	55 AMPS
Withstand Voltage:	2200 VAC, Test time 60 seconds
Mechanical	
Operating Temperature:	-40°C to +105°C -40°F to +221°F
Soldering Temperature:	260°C, 500°F for 5 seconds max.
Safety Approval:	UL US

Part Number Configuration.

VC1860-XX-000
 | |
 Number of Color
 Positions 0-Black

(Other Color Options Available)
 (Please consult Factory)

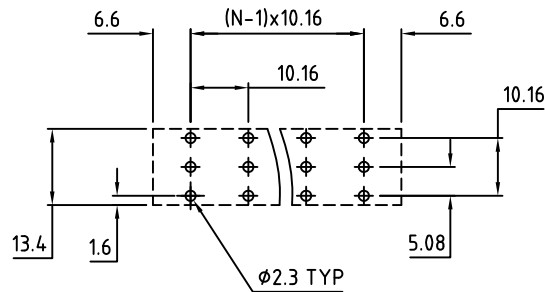

PCB Layout

MAX NUMBER OF POSITIONS = 8

UNLESS OTHERWISE SPECIFIED BREAK ALL SHARP EDGES AND DEBURR ALL HOLES

TITLE: 10.16mm SPACING, PLUGGABLE HEADER VERTICAL, CLOSED

LIMITS: UNLESS OTHERWISE SPECIFIED
 HUND.±.02 FRACT.±1/64
 THOU.±.005 ANGLE±1°

SCALE THIS IS A CONFIDENTIAL DRAWING AND MUSTBE TREATED AS SUCH. NO DISTRIBUTION IS ALLOWED WITHOUT WRITTEN APPROVAL BY EBYPLECTRO INC.



IMPORTANT DISCLAIMER: All information provided on this print is for reference. Always perform your own tests and acquire samples and further information to determine product suitability. While we make effort to provide accurate information, we cannot be responsible for errors either of omission or typographical. EBYPlectro, Inc. assumes no responsibility for the use or suitability of any product. All products and specifications are subject to change without prior written notice.

METRIC LIMITS ONE PLACE ±0.3 TWO PLACES ±0.10 ANGLE ±1°	DRAWN JM CHECKED APPROVED	DATE 01/22/08 DATE DATE	SIZE A	DRAWING NUMBER: VC1860-XX-000	REV. E
--	---------------------------------	-------------------------------	-----------	----------------------------------	-----------