

RoHS Compliant

Rev.

ECO#

Date

By

C

1590-0824

08/22/24

MWP

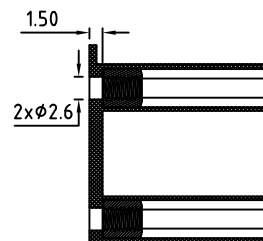
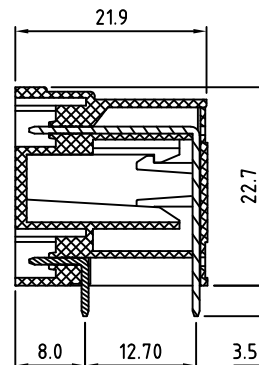
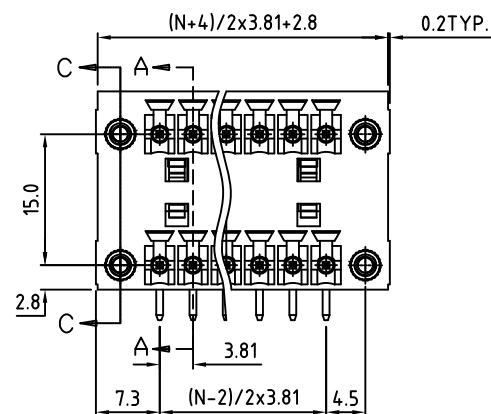

SECTION C-C

Material:	
Contact Solder Pins:	Copper, Tin Plated
Insulating Body:	Polyamide, UL94V-0, Green
Electrical	
Voltage Rating:	300 VAC
Current rating:	10 AMPS
Withstand Voltage:	1500 VAC, Test time 60 seconds
Mechanical	
Operating Temperature:	-40°C to +115°C -40°F to +239°F
Soldering Temperature:	260°C, 500°F for 5 seconds max.
Safety Approval:	CSA US

N=Number of Positions

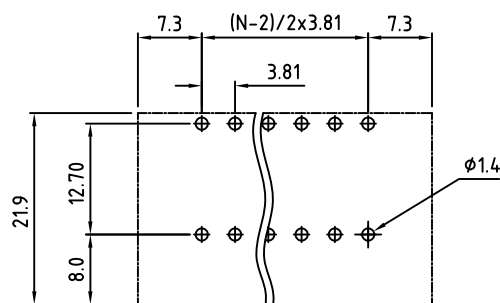

Recommended P.C.B. Layout

Part Number Configuration.

HC1381M-XX-X10

Number of
PositionsColor
0-Black
5-Green(Other Color Options Available)
(Please consult Factory)

Max Number of Positions = 48 (2x24) All Dimensions in Millimeters

TITLE: 3.81mm SPACING, PLUGGABLE BLOCK,
WITH MOUNTING ENDS, DUAL LEVELMETRIC LIMITS
ONE PLACE ± 0.3
TWO PLACES ± 0.10
ANGLE $\pm 1^\circ$

SCALE

THIS IS A CONFIDENTIAL DRAWING AND
MUST BE TREATED AS SUCH. NO
DISTRIBUTION IS ALLOWED WITHOUT
WRITTEN APPROVAL BY EBY ELECTRO INC.

Amphenol

EBY Electro Inc.
PLAINVIEW, NY 11803DRAWN MWP
CHECKED
APPROVEDDATE 04/04/07
DATE
DATESIZE
A

DRAWING NUMBER:

HC1381M-XX-X10

REV.
C

IMPORTANT DISCLAIMER: All information provided on this print is for reference. Always perform your own tests and acquire samples and further information to determine product suitability. While we make effort to provide accurate information, we cannot be responsible for errors either of omission or typographical. EBY Electro, Inc. assumes no responsibility for the use or suitability of any product. All products and specifications are subject to change without prior written notice.