

Note: 3P Cover for odd poles  
2p Cover for even poles

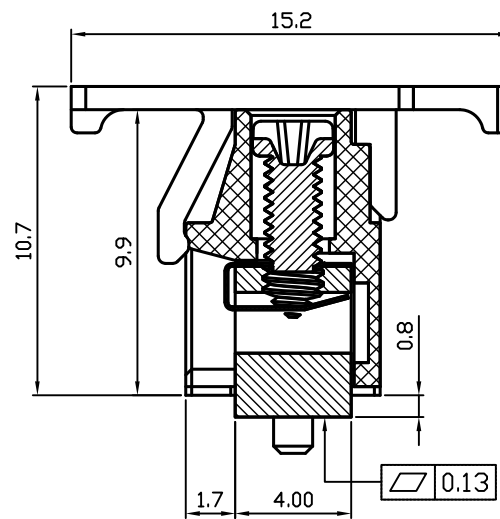
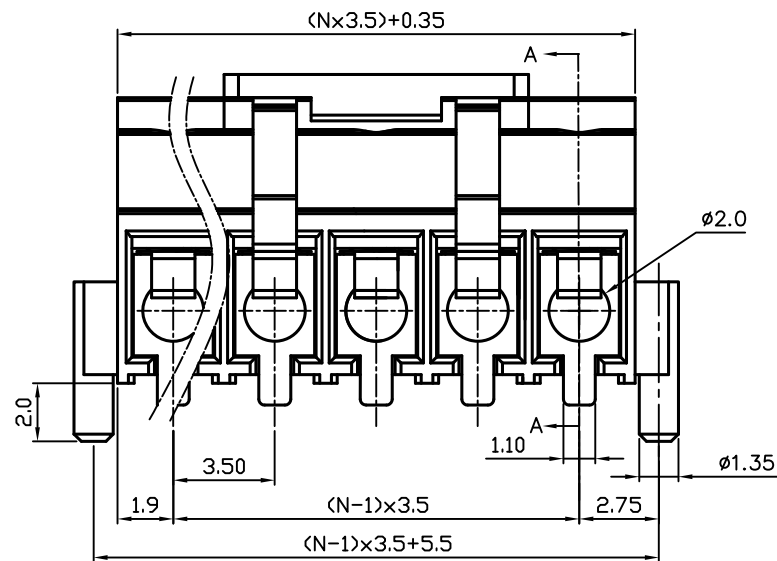

SECTION A-A

Material:	
Contact Solder Pin:	Brass, Tin Plated
Wire Guard:	Stainless Steel
Screw:	M2.0, Steel, Zinc Plated, Phil Slot
Insulating Body:	PA46, UL94V-0 Suitable for reflow
Cover:	PA46, UL94V-0
Electrical	
Voltage Rating:	150 VAC
Current rating:	10 AMPS
Withstand Voltage:	1500 VAC, Test time 60 sec
Wire Range:	16-26 AWG
Mechanical	
Torque:	2.0 Lbs-in. Max
Operating Temperature:	-45°C to +65°C -49°F to +149°F
Soldering Temperature:	280°C, 500°F for 5 seconds
Safety Approval:	UL US

### Part Number Configuration.

EB4510-XXDS-X0X

Number of Positions	Color	Packaging Option:
0	0-Black	0-Bulk, with polarizing pin -No Cover
1		1-Bulk, without polarizing pin -No Cover
2		2-Tape and Reel, with polarizing pin -With Cover
3		3-Tape and Reel, without polarizing pin -With Cover

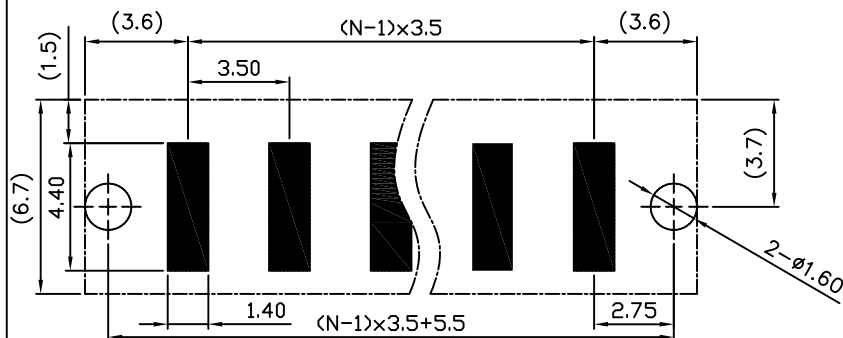

P.C.B. LAYOUT

Max Number of Positions = 16

UNLESS OTHERWISE SPECIFIED BREAK ALL SHARP EDGES AND DEBURR ALL HOLES	TITLE: 3.50mm SPACING, WIRE GUARD
LIMITS: UNLESS OTHERWISE SPECIFIED HUND.±.02 FRACT.±1/64 THOU.±.005 ANGLE±1°	SCALE: THIS IS A CONFIDENTIAL DRAWING AND MUSTBE TREATED AS SUCH. NO DISTRIBUTION IS ALLOWED WITHOUT WRITTEN APPROVAL BY EBY ELECTRO INC.
PLAINVIEW, NY 11803	

IMPORTANT DISCLAIMER: All information provided on this print is for reference. Always perform your own tests and acquire samples and further information to determine product suitability. While we make effort to provide accurate information, we cannot be responsible for errors either of omission or typographical. EBY Electro, Inc. assumes no responsibility for the use or suitability of any product. All products and specifications are subject to change without prior written notice.

METRIC LIMITS ONE PLACE ±0.3 TWO PLACES ±0.10 ANGLE ±1°	DRAWN: AJT CHECKED: _____ APPROVED: _____	DATE: 03/19/15 DATE: _____ DATE: _____	SIZE: A	DRAWING NUMBER: EB4510-XXDS-X0X	REV.
--	---	--	---------	------------------------------------	------