

N=Number of Positions

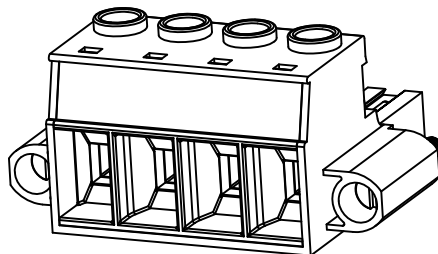
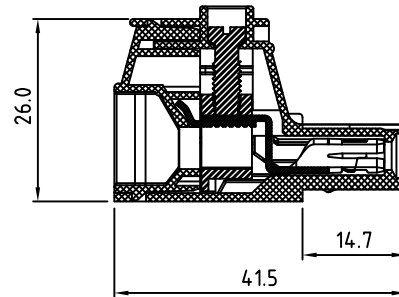
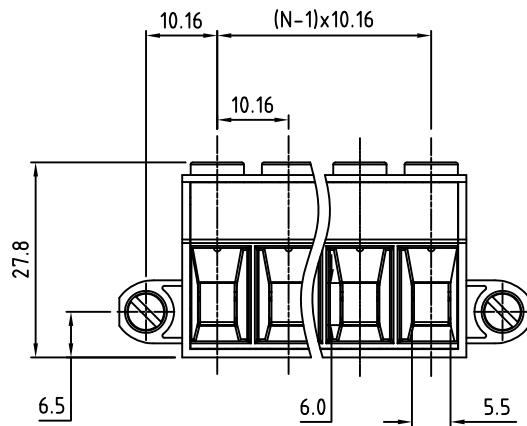

Material:	
Contact Block:	Brass, Nickel Plated
Contact Clip:	PhBz, Tin Plated
Screw:	M4, Steel, Zinc Plated, "-" slotted
Flange Screw:	M3, Steel, Zinc Plated, "-" slotted
Retainer Ring:	Stainless Steel
Insulating Body:	Polyamide, UL94V-0
Electrical	
Voltage Rating:	600 VAC
Current rating:	55 AMPS
Withstand Voltage:	2200 VAC, Test time 60 sec
Wire Range:	06-20 AWG
Mechanical	
Torque:	10.4lbs-in. Max
Operating Temperature:	-40°C to +105°C -40°F to +221°F
Safety Approval:	UL US

Part Number Configuration.

EB1860M-XX-000

Number of Positions      Color  
0-Black

(Other Color Options Available)  
(Please consult Factory)

Max Number of Positions = 8

UNLESS OTHERWISE SPECIFIED BREAK ALL SHARP EDGES AND DEBURR ALL HOLES	TITLE: 10.16mm SPACING, PLUGGABLE BLOCK MOUNTABLE	
	SCALE	THIS IS A CONFIDENTIAL DRAWING AND MUSTBE TREATED AS SUCH. NO DISTRIBUTION IS ALLOWED WITHOUT WRITTEN APPROVAL BY EBY ELECTRO INC.
LIMITS: UNLESS OTHERWISE SPECIFIED HUND.±.02      FRACT.±1/64 THOU.±.005      ANGLE±1°	DRAWN JM	DATE 01/22/08
	CHECKED	DATE
	APPROVED	DATE
DRAWING NUMBER: EB1860M-XX-000		REV. D



IMPORTANT DISCLAIMER: All information provided on this print is for reference. Always perform your own tests and acquire samples and further information to determine product suitability. While we make effort to provide accurate information, we cannot be responsible for errors either of omission or typographical. EBY Electro, Inc. assumes no responsibility for the use or suitability of any product. All products and specifications are subject to change without prior written notice.

METRIC LIMITS  
ONE PLACE ±0.3  
TWO PLACES ±0.10  
ANGLE ± 1°

DRAWN JM      DATE 01/22/08  
CHECKED      DATE  
APPROVED      DATE

SIZE  
A

DRAWING NUMBER: EB1860M-XX-000      REV. D