

N=Number of Positions

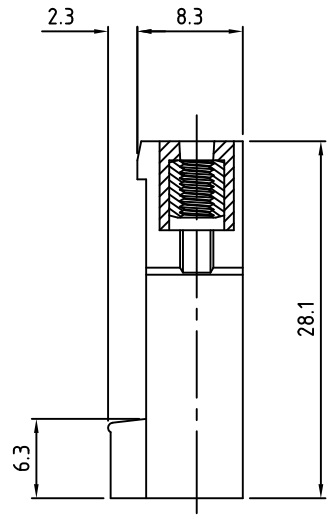
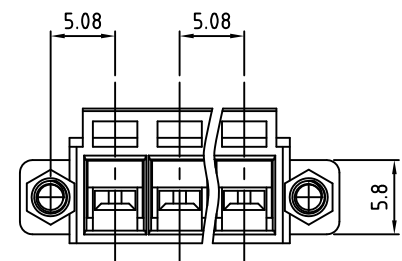

Material:	Polyamide, UL94V-0, Green
Voltage Rating:	300 VAC
Current rating:	10 AMPS
Mounting Nut:	M2.5, Brass
Withstand Voltage:	1500 VAC, Test time 60 seconds

Note:
- This block is a housing for a Crimpable Pin Insert, C1219-XX.

Part Number Configuration.
CH1581MN-XX-500
Number of Positions Color 5-Green

UNLESS OTHERWISE SPECIFIED BREAK ALL SHARP EDGES AND DEBURR ALL HOLES	TITLE: 5.08mm SPACING, PLUGGABLE HOUSING HIGH PROFILE, MOUNTING NUT		
	LIMITS: UNLESS OTHERWISE SPECIFIED HUND.±.02 FRACT.±1/64 THOU.±.005 ANGLE±1°	SCALE THIS IS A CONFIDENTIAL DRAWING AND MUSTBE TREATED AS SUCH. NO DISTRIBUTION IS ALLOWED WITHOUT WRITTEN APPROVAL BY EBY ELECTRO INC.	EBY Electro Inc. PLAINVIEW, NY 11803