

RoHS Compliant

| | | | |
|------|-----------|----------|-----|
| Rev. | ECO# | Date | By |
| A | 0206-0812 | 08/06/12 | MWP |

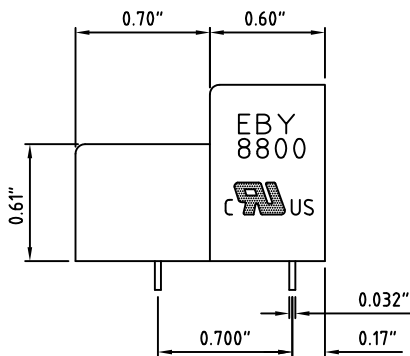

N=Numbers of Positions

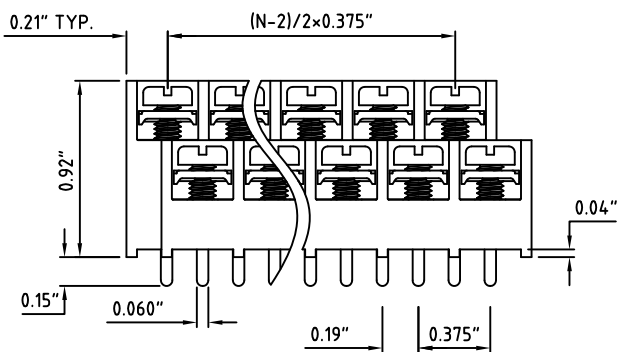
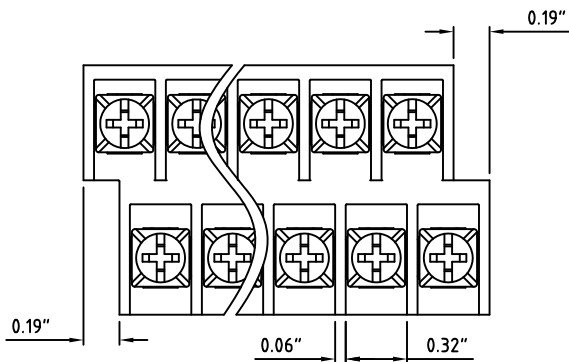
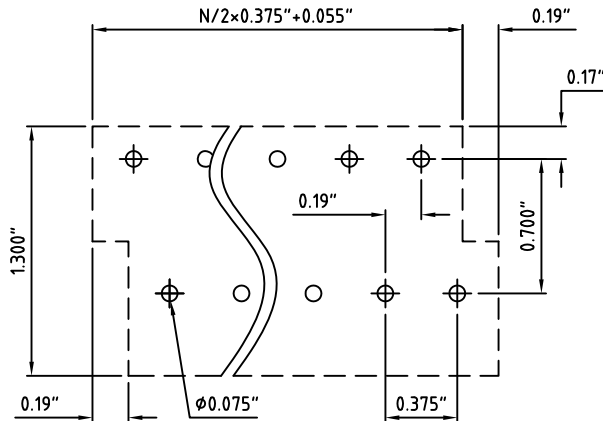

PCB Layout

| Material: | |
|------------------------|------------------------------------|
| Contact Solder Pin: | Brass, Tin Plated |
| Insulating Body: | Polycarbonate, UL94V-0, Black |
| Terminal Screw: | #6-32, See Chart |
| Electrical | |
| Voltage Rating: | 300 VAC |
| Current rating: | 20 AMPS |
| Wire Range: | 12-22 AWG |
| Withstand Voltage: | 1500 VAC, Test time 60 seconds |
| Mechanical | |
| Torque: | 10.0 lbs-in. Max. |
| Operating Temperature: | -40°C to +115°C -40°F to +240°F |
| Soldering Temperature: | 260°C, 500°F for 5 seconds max. |
| Safety Approval: | |

Part Number Configuration

8802-XX-N-XX

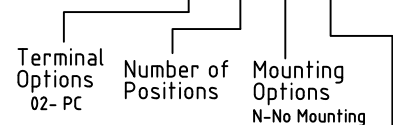

Screw Options

- 00 - No Screws
- 01 - Steel, Zinc Plated
- 02 - Steel, Zinc Plated, w/ Washer
- 03 - Brass, Nickel Plated
- 04 - Brass, Nickel Plated, w/ Washer
- 05 - Stainless Steel, Phillips Head
- 11 - Steel, Zinc Plated, Captive
- 12 - Steel, Zinc Plated, Captive, w/ Washer
- 13 - Brass, Nickel Plated, Captive
- 14 - Brass, Nickel Plated, Captive, w/ Washer
- 21 - Steel, Zinc Plated, Captive, Wire Ready
- 22 - Steel, Zinc Plated, Captive, Wire Ready, w/ Washer
- 23 - Brass, Nickel Plated, Captive, Wire Ready
- 24 - Brass, Nickel Plated, Captive, Wire Ready, w/ Washer
- 46 - Steel, Zinc Plated, Thread Interrupt, Wire Ready, w/ Washer

Max Number of Positions = 2x20=40

| | |
|---|--|
| UNLESS OTHERWISE SPECIFIED BREAK ALL SHARP EDGES AND DEBURR ALL HOLES | TITLE: 0.375" SPACING, BARRIER BLOCK DUAL LEVEL, STAGGERED |
|---|--|

| | | | |
|---|-------|---|-------------------------------------|
| LIMITS: UNLESS OTHERWISE SPECIFIED HUND.±.02 FRACT.±1/64 THOU.±.005 ANGLE±1° | SCALE | THIS IS A CONFIDENTIAL DRAWING AND MUSTBE TREATED AS SUCH. NO DISTRIBUTION IS ALLOWED WITHOUT WRITTEN APPROVAL BY EBYS ELECTRO INC. | Electro Inc. PLAINVIEW, NY 11803 |
|---|-------|---|-------------------------------------|

IMPORTANT DISCLAIMER: All information provided on this print is for reference. Always perform your own tests and acquire samples and further information to determine product suitability. While we make effort to provide accurate information, we cannot be responsible for errors either of omission or typographical. EBYS Electro, Inc. assumes no responsibility for the use or suitability of any product. All products and specifications are subject to change without prior written notice.

| | | | | | |
|--|---------------------------------|-------------------------------|--------|---------------------------------|-----------|
| METRIC LIMITS ONE PLACE ±0.3 TWO PLACES ±0.10 ANGLE ±1° | DRAWN JM CHECKED APPROVED | DATE 03/22/11 DATE DATE | SIZE A | DRAWING NUMBER: 8802-XX-N-XX | REV. A |
|--|---------------------------------|-------------------------------|--------|---------------------------------|-----------|