

RoHS Compliant

Rev.

Description/Eco

Date

By

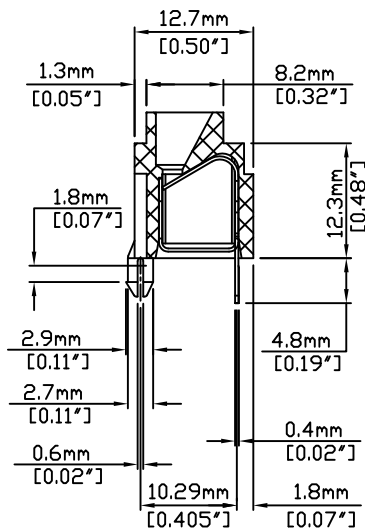
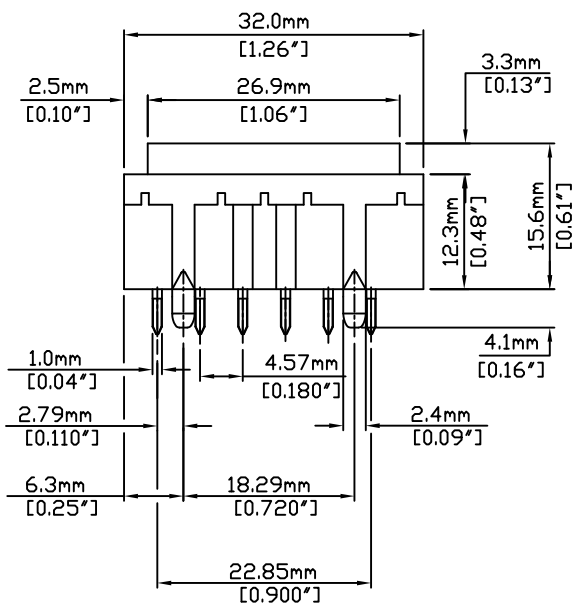
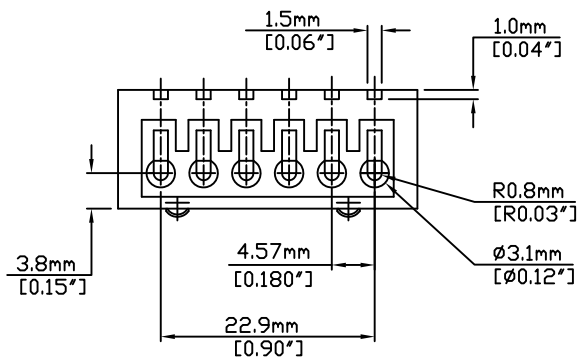

Material:	
Contact Solder Pin:	PhBz, Tin Plated
Insulating Body:	Polyamide, UL94V-0, White
Electrical	
Voltage Rating:	300 VAC
Current rating:	2 AMPS
Withstand Voltage:	1500 VAC, Test time 60 sec
Wire Range:	18 AWG
Mechanical	
Operating Temperature:	-40°C to +105°C -40°F to +221°F
Soldering Temperature:	260°C, 500°F for 5 seconds
Safety Approval:	CE US

Part Number Configuration.

EB416-06-900

Number of Positions: 6  
Color Option: 9-White

(Other Color Options Available)  
Please consult Factory

UNLESS OTHERWISE SPECIFIED BREAK ALL SHARP EDGES AND DEBURR ALL HOLES  
TITLE: 4.57mm SPACING, SCREWLESS BLOCK

LIMITS: UNLESS OTHERWISE SPECIFIED  
HUND.±02 FRACT.±1/64 THOU.±005 ANGLE±1°  
SCALE THIS IS A CONFIDENTIAL DRAWING AND MUSTBE TREATED AS SUCH. NO DISTRIBUTION IS ALLOWED WITHOUT WRITTEN APPROVAL BY EBYS ELECTRO INC.  
EBY Electro Inc. PLAINVIEW, NY 11803

IMPORTANT DISCLAIMER: All information provided on this print is for reference. Always perform your own tests and acquire samples and further information to determine product suitability. While we make effort to provide accurate information, we cannot be responsible for errors either of omission or typographical. EBYS Electro, Inc. assumes no responsibility for the use or suitability of any product. All products and specifications are subject to change without prior written notice.  
METRIC LIMITS ONE PLACE ±0.3 TWO PLACES ±0.10 ANGLE ±1°  
DRAWN JM DATE 07/24/07  
CHECKED DATE  
APPROVED DATE  
SIZE A DRAWING NUMBER: EB416-06-900  
REV.